

# REMOVABLE BEAM COVER M'16

**3652**

KEEP THIS  
DOCUMENT



## Warning

This equipment should be installed by a qualified individual.

This equipment should only be used by one person at a time, under the supervision of a qualified individual.

Using this equipment for purposes other than those originally intended is prohibited.

## Recommendations

As set out in French Standard NF S52-400 the following is recommended:

- keep these instructions for subsequent reference (inspection, maintenance, etc.).
- periodically carry out predictive maintenance.
- depending on how much it is used have the equipment serviced yearly or every few years.

## Pack list

1 Pack (Ref: 3652)

Dimensions: 610 x 410 x 240 mm

Weight: 6 kg

Volume: 0.06 m<sup>3</sup>

## I. Assembly of the cover

**1** Wipe over the existing body with a dry cloth to remove any unwanted particles (fragments of magnesium, etc.).

**2** Use the end caps (**4**) provided if necessary (end caps damaged or non-existent) for Gymnova beam bodies. Refer to instructions NM135.

**3** Fit the new cover (**1**) over the existing body: start with one end then fit the other end.

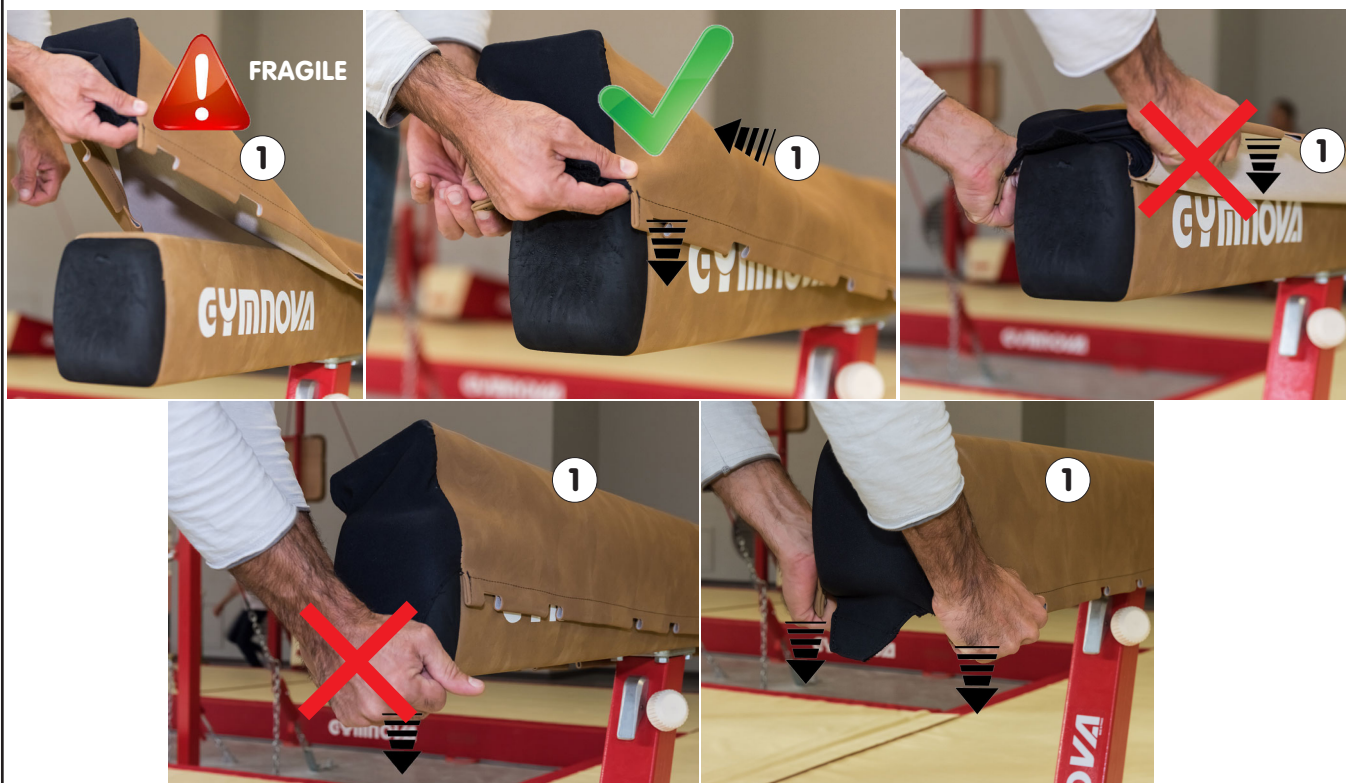

- 4** Check that the cover (1) is properly centred on the body: lengthwise (same fabric fit at both ends) and equally balanced on both sides.

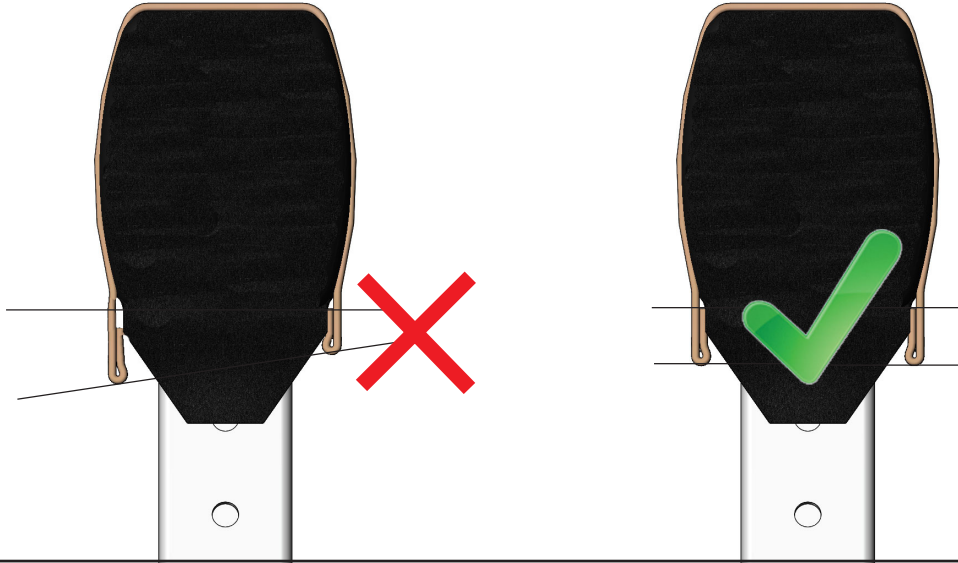

- 5** Thread a rod (2) through each hem along the full length of the cover (1).

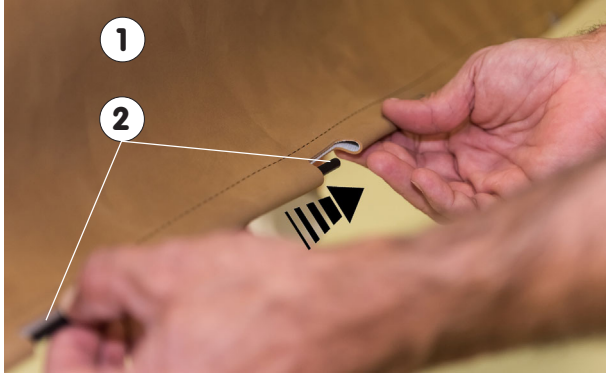

- 6** Insert the rods (2) into each "pocket" at the ends of the cover (1).

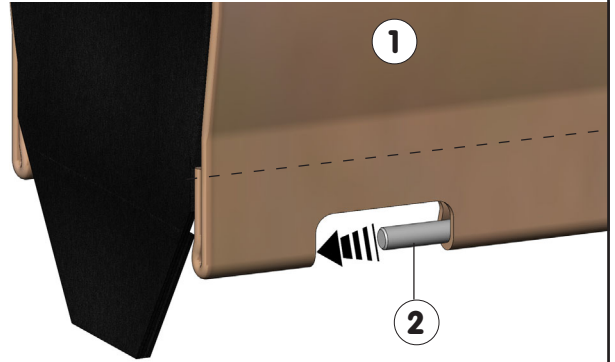

- 7**  **The rods are slightly longer than the cover:** therefore you need to insert one end into a pocket (step 6), then push the rod as far as it will go in the direction shown in step 6 in order to insert the other end into the second pocket.

- 8** Position the 28 self-gripping strips (3) around one rod (2) along the same side, through each slot in the removable cover (1).

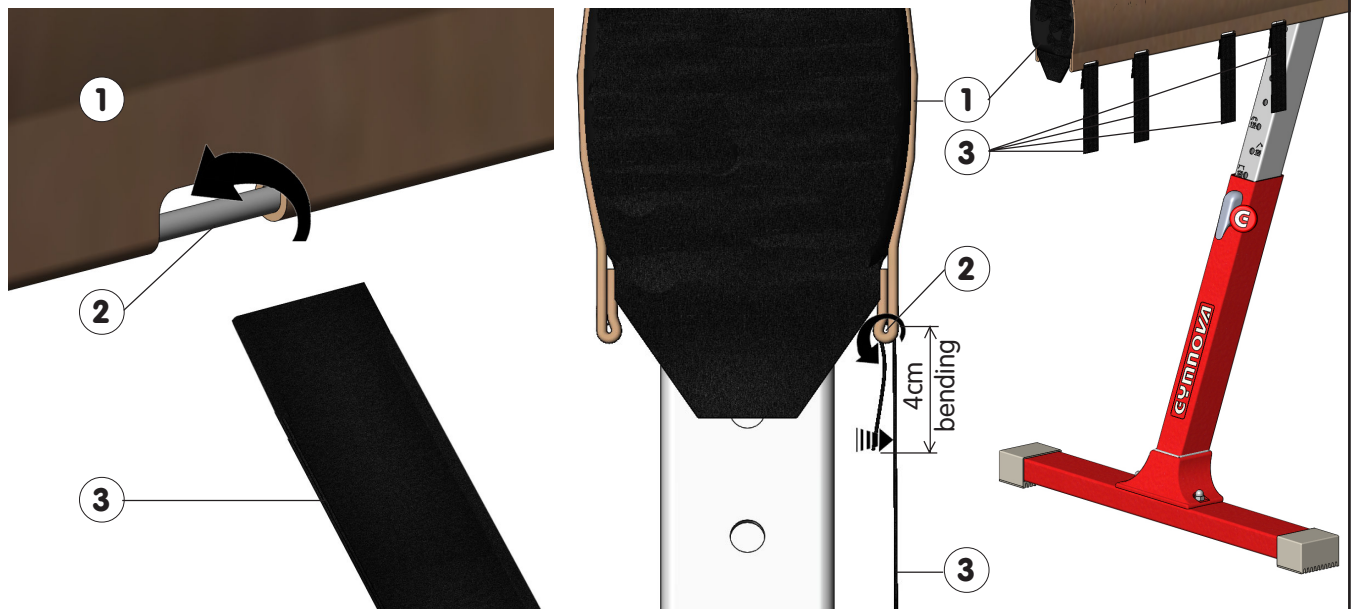

- 9** Start at one end of the beam and repeat the operation on each self-gripping strip **(3)**. Pull each strip with moderate force to tighten the cover **(1)**. Once all the self-gripping strips are attached, adjust by tightening them further if necessary.



Each time you tighten a self-gripping strip check that the cover is still properly centred on the body = does not "slip around" relative to the body (see Fig 4).

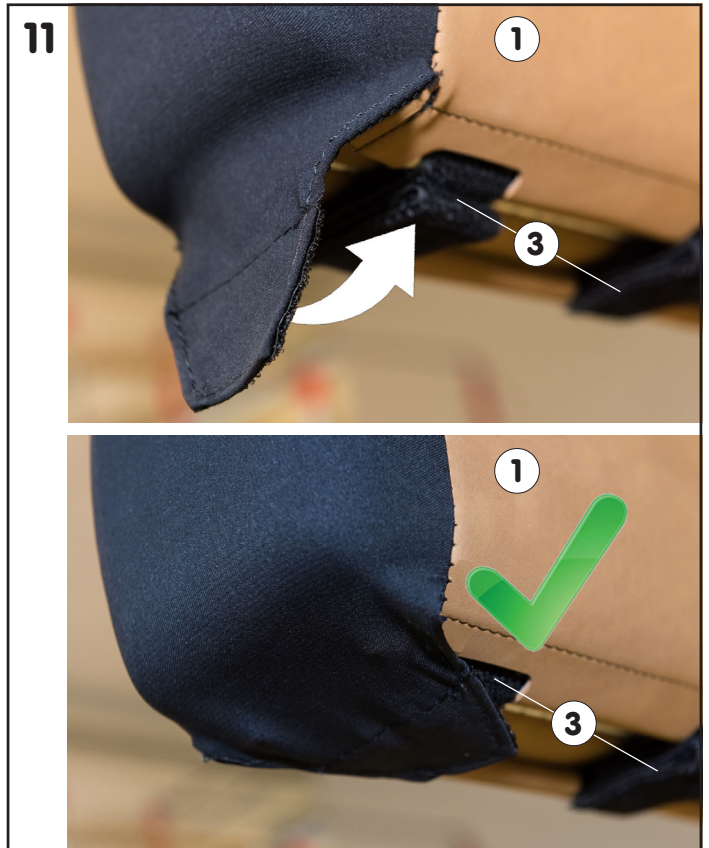
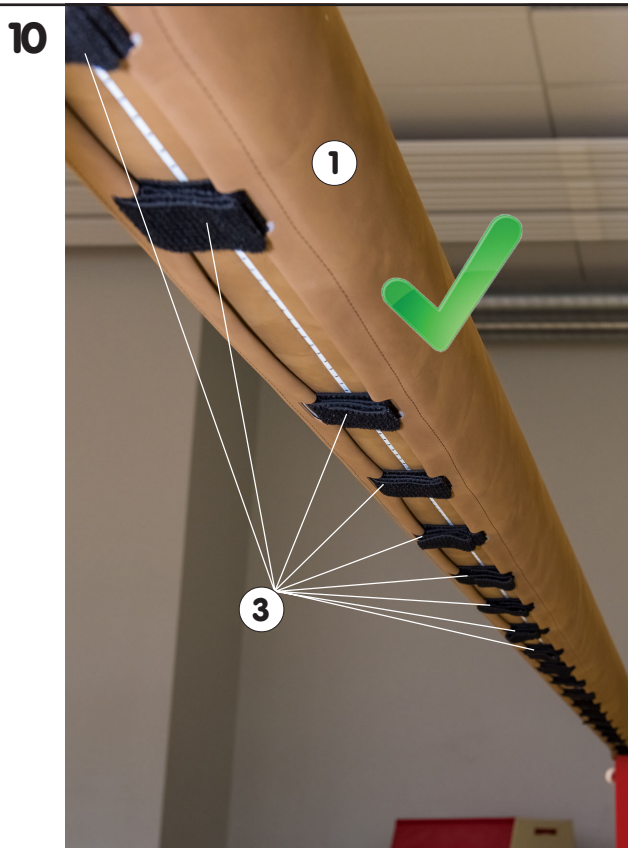
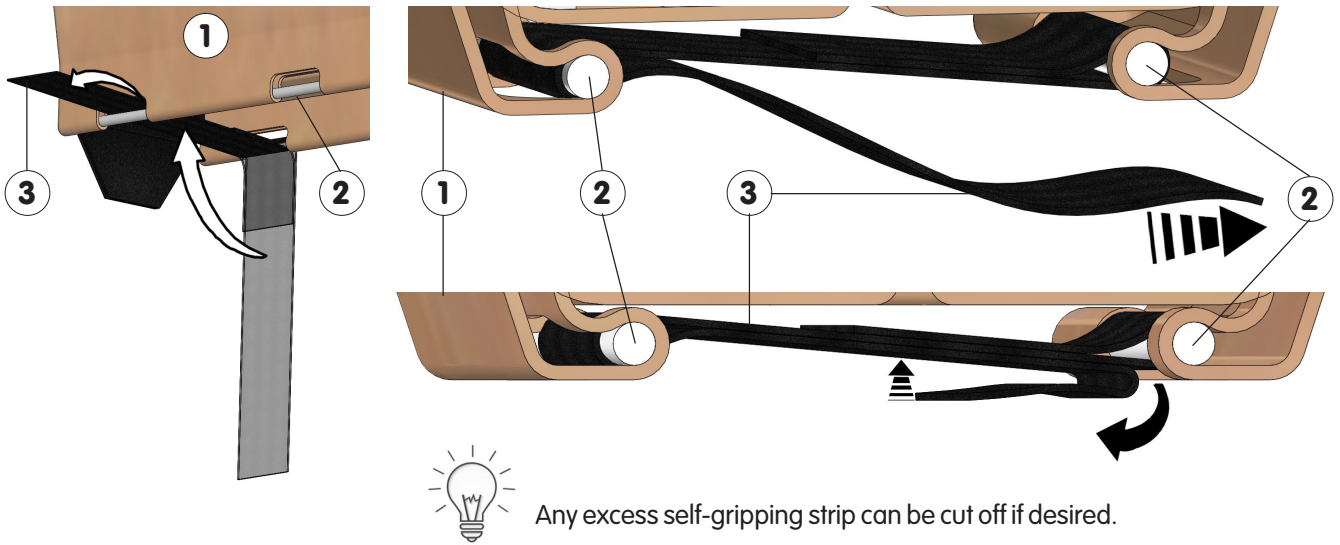

## II. Maintenance

Before each use, make a thorough check on good condition and correct operation of wear parts (self-gripping strips). Re-tighten all the self-gripping strips if the cover is loose.

### Important:

- If a problem is found or suspected, do not use the equipment until it has been checked by a technician.
- Any damaged or distorted component should be replaced as quickly as possible.



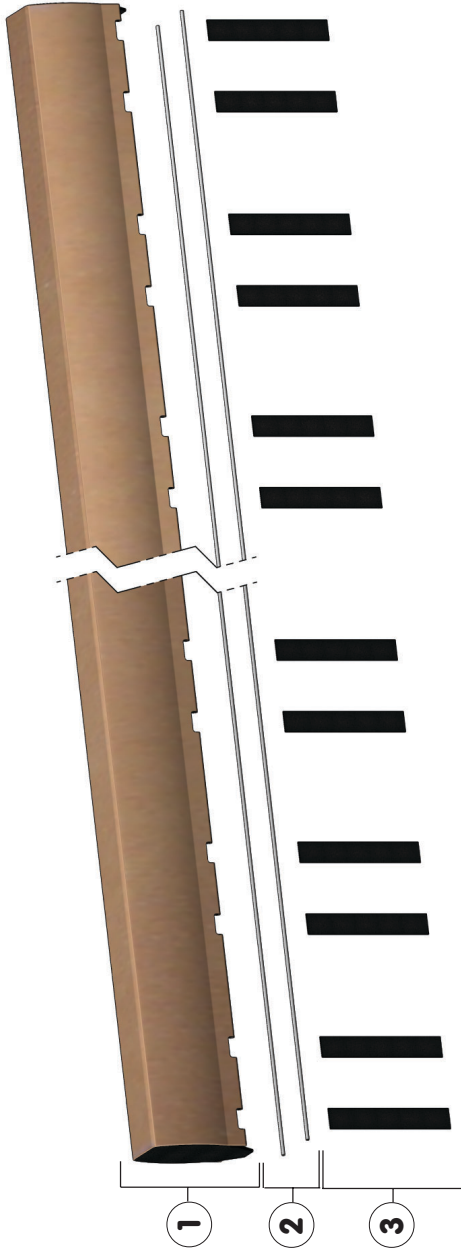

30	-	-	-	-
29	-	-	-	-
28	-	-	-	-
27	-	-	-	-
26	-	-	-	-
25	-	-	-	-
24	-	-	-	-
23	-	-	-	-
22	-	-	-	-
21	-	-	-	-
20	-	-	-	-
19	-	-	-	-
18	-	-	-	-
17	-	-	-	-
16	-	-	-	-
15	-	-	-	-
14	-	-	-	-
13	-	-	-	-
12	-	-	-	-
11	-	-	-	-
10	-	-	-	-
9	-	-	-	-
8	-	-	-	-
7	-	-	-	-
6	-	-	-	-
5	2	Set of 14 self-grip. strips	3652/22	Service kit
4	2	Complete plastic end cap	3610/77	each
3	28	Self-gripping strip	-	-
2	1	Pair of rods Ø6 - Length: 5025	3652/12	-
1	1	Removable Cover M'16	3652/03	-
ITEM	QTY	DESCRIPTION	REFERENCE	REMARKS

# REMOVABLE BEAM COVER M'16