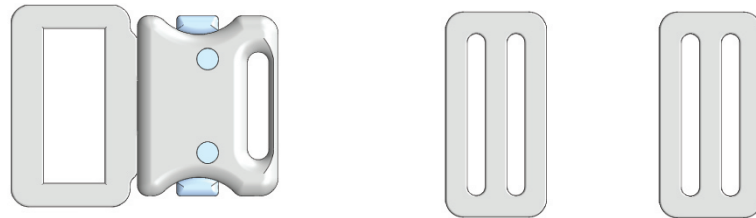

**REPAIR KIT : METAL BUCKLE
FOR INITIATION RINGS**

3710/10

KEEP THIS
DOCUMENT**Warning:**

This equipment should be installed by a qualified individual.
The apparatus should only be used under the supervision of a qualified individual.
Using this equipment for purposes other than originally intended is not allowed.

Recommendations:

As shown in french standard NF S52-400 the following are recommended :

- keep these instructions for subsequent reference (inspection, maintenance...)
- periodically carry out predictive maintenance
- depending on how much it is used, have the equipment serviced yearly or every few years.

Packaging:

- 2 double metal adjusters **(1)**
- 1 complete metal automatic buckle : male part **(2)** & female part **(3)**
Dimensions : 160 x 110 x 110mm Volume : 0.002 m³ Weight : 0.26kg

I. Disassembly of the previous plastic buckle

1 Unstitch the strap extremity of the female plastic buckle part

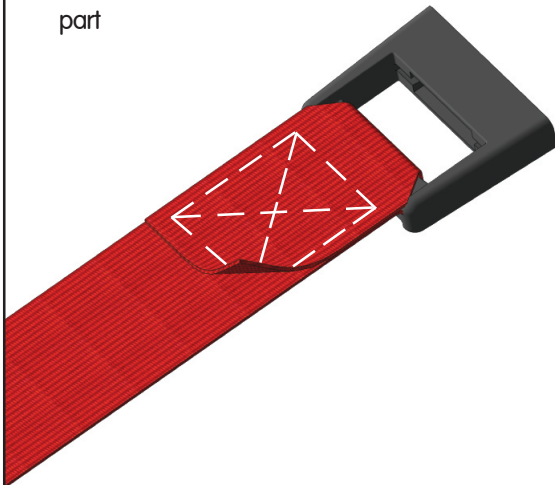

2 Slide & remove the male plastic buckle part from the strap

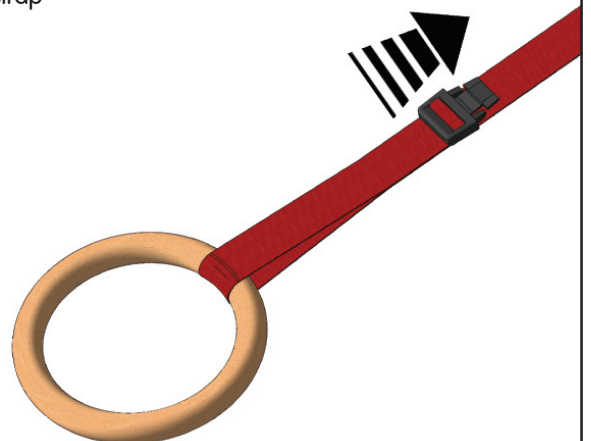

II. Assembly of the new metal buckle

3 Thread the strap through the metal male part (2) & a double adjuster (1)

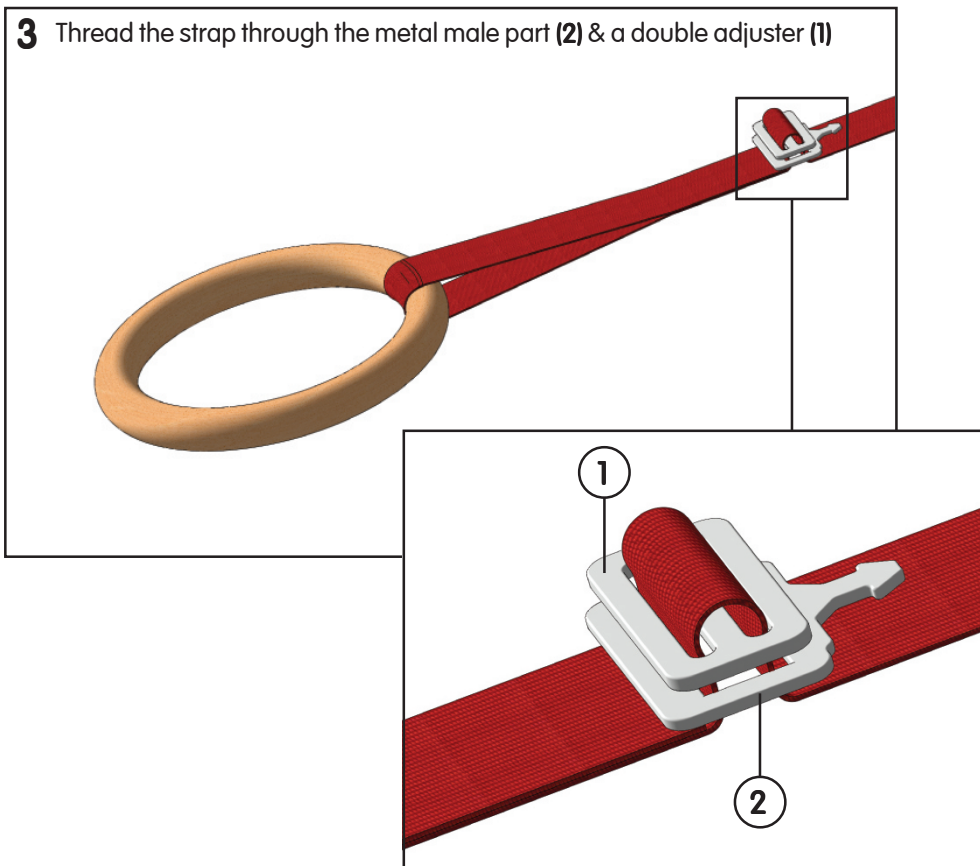

4 Finish assembling the metal female part (3) & the second double adjuster (1)

